

# CONCAVE 16

UPPERSOUTHCLAVE XXV

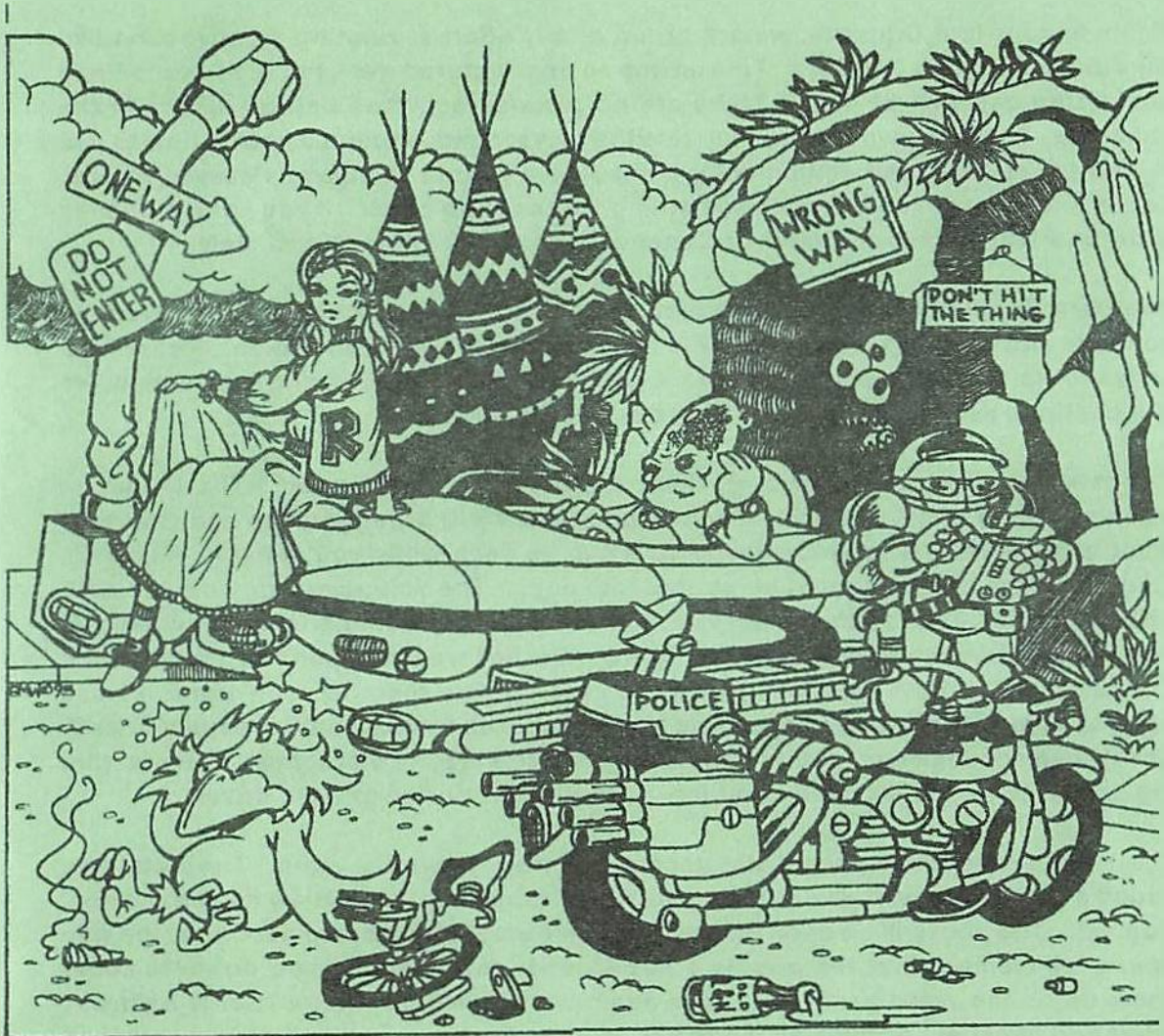

**FEBRUARY 24-26. 2005**  
**PARK CITY, KENTUCKY**

# GRUMBLES FROM THE CAVE

OK, who took that year while I wasn't looking? The last weekend of February seems to sneak up on me faster each year. It's been an good experience handling the hotel booking myself. I feel I know many of you better since we've worked together to fill the hotel. For those of you who didn't get a room, we will start booking rooms for Concave 17 on Sunday. Since I did the room assignments myself, there are hopefully some improvements this year. I have reserved the far end of the hotel as a quiet zone. Room numbers 138-155 and 235-256 have been given to those requesting quiet. Please respect these people, and avoid noise in these sections.

If this is your first Concave, we are proud of our effort at running a convention like they did in the Good Old Days. This means an unstructured weekend of relaxation and socializing between SF fans. There are no planned activities beyond what's in the schedule. The Concave staff will provide the playground, you must decide how to use it. Our space, staff, and equipment is limited, so we won't be able to please everyone. Let us know, however, if there's something we could do better. If you have problems with the Park Mammoth Resort or Concave staff, let us know immediately.

The Barn Room is a NO SMOKING area. The Patio Room will serve as the overflow consuite and smoking area. We'll hold the art auction in the Barn Room. Please help us while we move the furniture. For those thirsty folks exiled during the auction, we will continue service through the side door of the kitchen.

Concave has few rules, however, there are some we insist upon. The minimum drinking age in Kentucky is 21. You will be asked for ID at registration and wherever alcohol is served. Wear your badge so it can be seen while you're here. All drinks taken from the consuite must be poured into cups. The volunteers serving you ARE THE BOSS. If you are refused service, you are probably doing something wrong. If you have a problem with that, come to me. Do not wear weapons or imitations at Concave. If you have weapons or toys, please confine them to your room. Please heed all posted rules of the hotel. The watchman is an Edmonson Co. deputy sheriff. Unruly behavior can land you in the county jail. We will eject disruptive elements from the convention. Finally, when you leave, do it sober or designate a driver.

The hotel services are essentially unchanged from previous years. The hotel has added a hot tub somewhere, but the state health inspector won't allow it to be opened. Bummer. The pool will be open for the duration except for cleaning periods in the wee hours. Remember that the pool is a public area, and anything you do there could show up on the video program! Once again we will feature the traditional Saturday afternoon banquet. Admission is \$10 per person. Seating is limited, so buy early and often. WE ♥ VOLUNTEERS! Helpers in the consuite, art show, and auction are always extremely welcome. There will be a sign-up sheet posted on the cabinet doors in the Barn Room kitchen for anyone interested in working. It's a great way to meet people. As always, we hope that this is the best Concave ever! Go and enjoy!

Gary R. Robe

# SCHEDULE OF EVENTS

## FRIDAY, FEBRUARY 24

- NOON                    Registration opens -- Hotel Lobby  
                              Consuite opens -- Barn Room, Patio Room<sup>1</sup>  
                              Huxter Room setup -- Blue Room  
                              Art Show setup -- Rooms 134-136
- 5:00 PM                Huxter Room, Art Show, Gaming rooms (234-236), and  
                              Video Room (266) open.<sup>2</sup>
- 7:00 PM                Opening Ceremonies -- Patio Room

<sup>1</sup> The Barn Room is a NO SMOKING area. SMOKING is permitted in the Patio Room.

<sup>2</sup> The opening times of these functions are approximate, and depend on the speed of setup. Volunteers are always welcome. The closing time for these functions is not set and will be determined by the people responsible for running them.

NOTE There WILL be room parties! Look for announcements.

## SATURDAY, NOVEMBER 25

- 10:00 AM              Registration, Art Show, Huxter room, and Gaming reopen.
- 12:30 PM              Registration closes. Late registration in the Barn Room.
- 1:00 PM                Banquet & Guest of Honor speeches -- Hotel restaurant.
- 6:00 PM                Art Show closes for bidding.
- 8:00 PM                Art Auction -- Barn Room

## SUNDAY, FEBRUARY 27

- 10:00 AM              Art Show checkout: no sales after 11:00 a.m.
- 11:00 AM              Business and site selection meeting --Room 266.
- NOON                   Hotel checkout. Gaming closes
- ??:?? PM              Huxter Room closes. Dead dog party for the survivors.  
Volunteers working on teardown get a pizza supper on Concave's tab.

## *Fannus Omnivorous*

-or-

## The Multiplex Fen

by Edie Stern & Joe Siclari

In these degenerate times, it's not a given that you can easily find people with that old time scientificational fannish virtue -- that of being an omnivorous fan. You know, the fan that is interest in everything SF and fandom are about and active in most of it. Say hello to *two* of the, you Guests of Honor, Judy Bemis and Tony Parker.

Their reading goes from hard SF to fantasy. Check out their neato wedding rings. They apa-hack. They've been known to edit local SF club newsletters. They filk (Judy with the voice and guitar, and Tony mostly satisfied with a big appreciative grin on his face, interspersed with a baritone *a cappella*. Tony was once nearly thrown out of a Delta Crown Room in Michigan for misplaced filking. I know. We were *very* young.) They collect art. Invite them to an art auction -- it couldn't hurt. They even smof.

Smoffing is a fine craft. It's educational, creative, hard work that allows you to develop obligations to other responsible and intellectually facile fans who spend their time doing organizational silliness so that others may enjoy the club, or the con, or the hoax. Tony and Judy are smoffers without a doubt. From the sublime local endeavors of the South Florida Science Fiction Society and the Coral Springs Science Fiction League, Social Drinking Society and Travelling Fanvariety Show (In Exile), to the ridiculous intergalactic labors of MagiCon, these two have been in it up to their armpits.

Tony has been a stalwart of South Florida fandom since the late seventies (and was 1/3 of Boca Raton fandom for a looong time.) Judy has been active even longer in the Washington DC area first, and later down in Florida. They've run consuites, and registration, and dealer's rooms, and who knows what-all else. Together, they have even chaired conventions. Plural.

Judy was Treasurer of MagiCon. If you ask her about MagiCon, be prepared to sit and listen for a long time, and drink some too. Tony was CFO of the corporation. Tony and Judy were very active on the bid for the three long



years of it, and the prep work for the con itself took another three. And three years after MagiCon, they are still involved with it. They single-handedly ran about a billion bid parties at conventions all over the country and beyond. Do the words persevering, tenacious, and steadfast sound appropriate? How about travel-broke?

So. Watch out for them and make nice. They're willing to try most anything at least once, and always ready to learn something new. Among other things, they drink port and sweet wine (and prefer it "chewy"). They are gregarious and hospitable, and will sit up all night talking or singing, or partying, or snuffing. They just recently left South Florida as Tony's job has relocated them to North Carolina. We miss them already.

And we really meant omnivorous -- ethnic foods and chocolate are their specialties. They have been known to bring kilograms of chocolate home from thousands of miles away. If you mention sushi, Judy will follow you anywhere, and Tony will certainly find something on the menu to his liking.

# VIDEO PROGRAM

**NOT AVAILABLE AT PRESS TIME:**

**CHECK THE SIGNS OUTSIDE ROOM 266**

## BANQUET MENU:

*Baked Chicken with Dressing*

*Barbeque Ribs*

*Au Gratin Potatoes*

*Broccoli Casserole*

*Mixed Vegetables*

*Salad Bar*

*Blackberry Cobbler*

*Peach Cobbler*

*Choice of Drink*

## PARK MAMMOTH RESORT

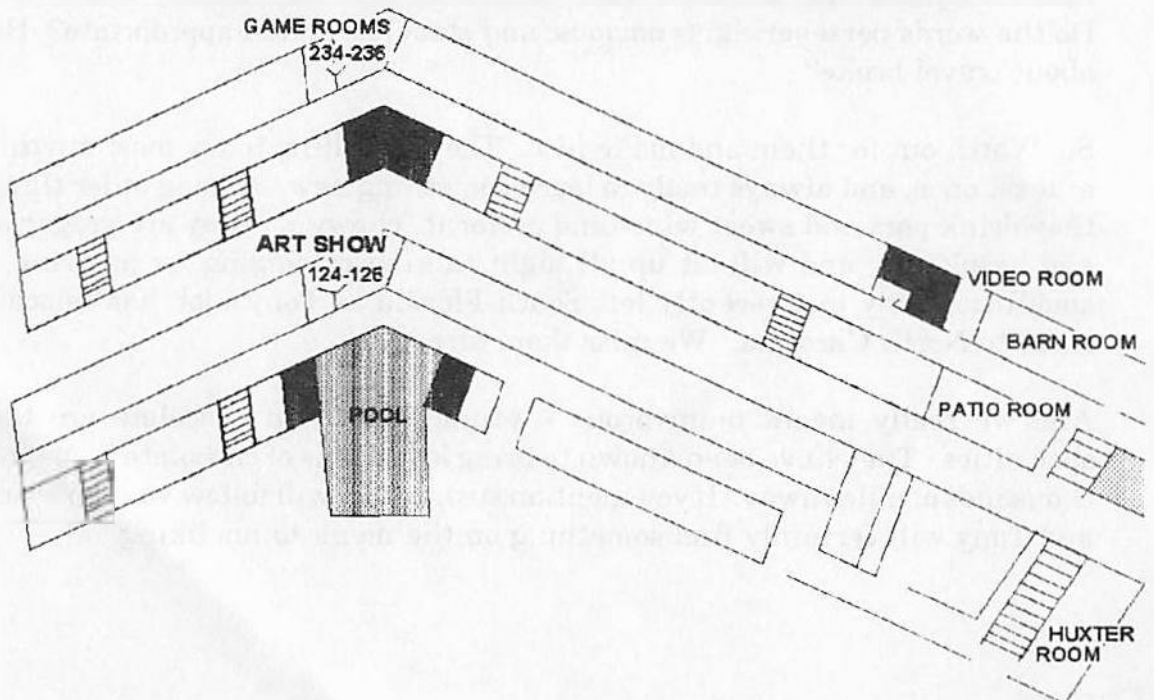

# A FAN'S GUIDE TO THE CAVE AREA

**FOOD:** The Park Mammoth Resort (PMR) restaurant is a perennial fannish favorite with their excellent home-style cooking and their justly famous cinnamon rolls. If you want to explore, turn left on US 31-W (the main road running in front of the hotel), and drive 6 miles to KY 90 in Cave City. To the left you are in fast food nirvana. If you are looking for something fancier, Bowling Green offers several choices within a 30 minute drive. Ask the con staff for recommendations and directions.

**DHRINK:** If you need something that's not in the Consuite you'll discover you are in a desert, and the nearest oasis is Bowling Green. Again, ask the con staff for directions.

**SHOPPING:** There is an outlet mall in Horse Cave just 10 miles to the north on I-81. Bargains are mixed with rip-offs, so let the buyer beware! There is also an ATM located inside one of the restaurants in the center of the mall. If this machine is not your flavor, ask for directions to Bowling Green.

**GASOLINE:** There are two gas stations on KY 255 in Park City. There are other flavors including a 24 hour Super America in Cave City.

**CAVE TOURS:** Mammoth Cave National Park is one of the world's most popular tourist attractions, and is located about 8 miles from PMR on KY 255. The way is well marked. The PMR front desk has a tour schedule. The tours often sell out, so make reservations as soon as possible. Advance tickets are available. Plan to get to the Visitor's Center two hours before tour departure.

**THE RESORT:** PMR is an integral part of Concave's success. It has many features that are unusual for a SF con hotel. The front desk can equip you for the saunas or miniature golf. Pool cues can be checked out in the consuite. The riding stables may be open if weather permits. Follow your nose to find them! The mini-train is not running, but walking 1.5 mile track is a Concave tradition in good weather. Other favorite outdoor activities include a walk to Lookout Point and the Tilt House, plus the tennis courts, playground, and 18 hole golf course.

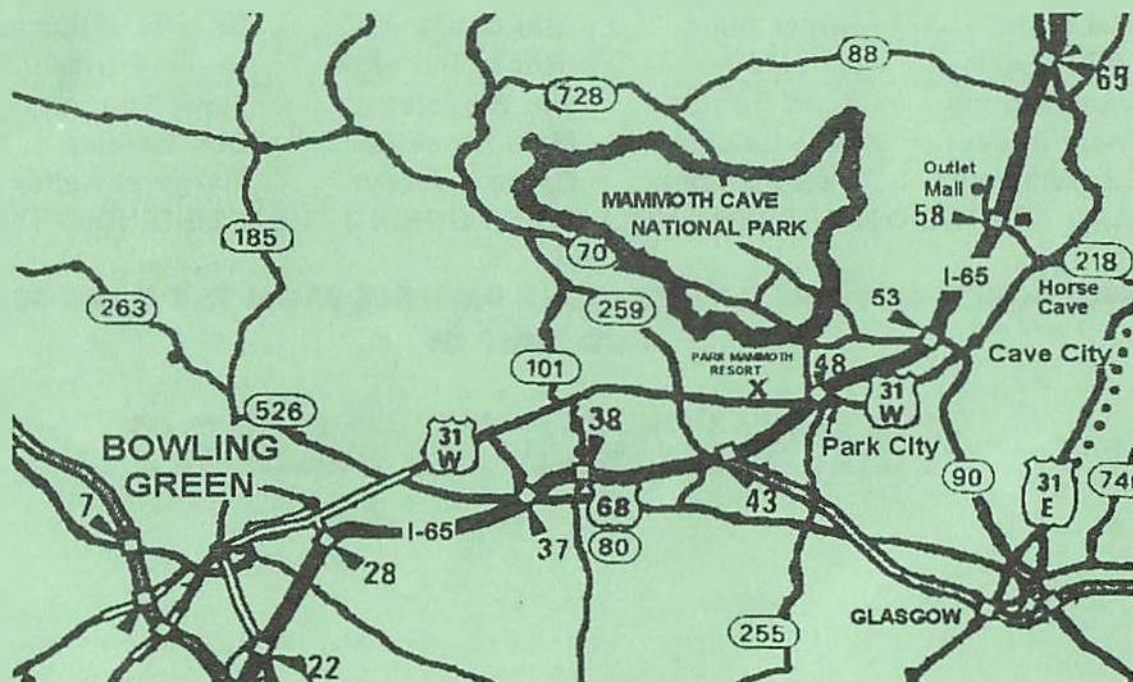

# ACKNOWLEDGEMENTS

## THE CONCAVE 16 COMMITTEE:

ANNETTE CARRICO--*Consuite Coodinator*  
STEVE FRANCIS--*Huxter Room Honcho*  
CORLIS ROBE--*Registrar Royale*  
GARY ROBE--*Scapegoat Supreme*  
RICKEY SHEPPARD--*Shadowy Masonic Influence*

## THANKS THESE FRIENDS FOR THEIR CONTRIBUTIONS:

SUE FRANCIS--Consuite 1 <sup>st</sup> Officer	JOE SICLARI--GoH Intro.
JOHN HANS--Game Room	EDIE STERN--GoH Intro.
PATTY TEAGUE--Game Room	KENNY REASONER--Video Room
PAT MOLLOY--Art Show	NAOMI FISCHER--Art Show
GARY M. WILLIAMS--Flier/Cover Art	

*And the ever faithful elevator committee: Our most uplifting members!*

## AND SOME OF THE FEN WHO WERE DRAFTED VOLUNTEERED:

Pat Sims	Roger Sims	Bill Cavin	Gary M. Williams
John Hollis	Ken Moore	Rocky Halleron	Bryan Porter
Jane Dennis	Scott Dennis	Jim Woosley	Jann Melton
Mary Baker	Mike Lalor	Mark Linneman	Bob Embler
Liz Williams	Dick Spelman	Debra Hussey	Margaret Keifer

AND ALL THE OTHERS WHO VOLUNTEER DURING THE WEEKEND--THANKS!

AND FOURTEEN YEARS OF INCREDIBLE PATIENCE FROM THE MANAGEMENT AND STAFF OF

# PARK MAMMOTH RESORT